

Family, housing and household in early modern London

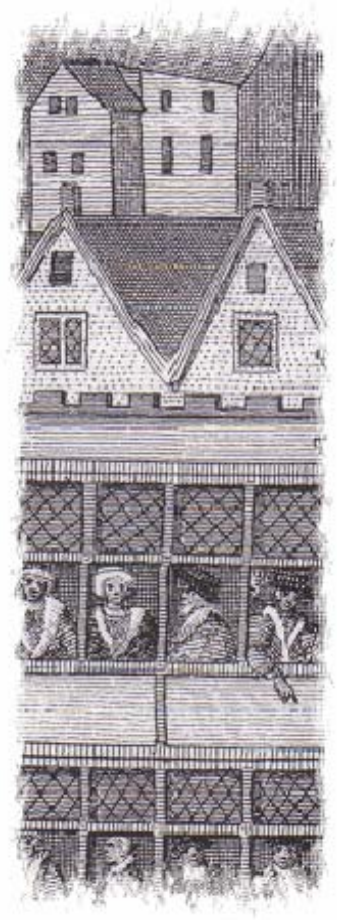

Sample Parishes

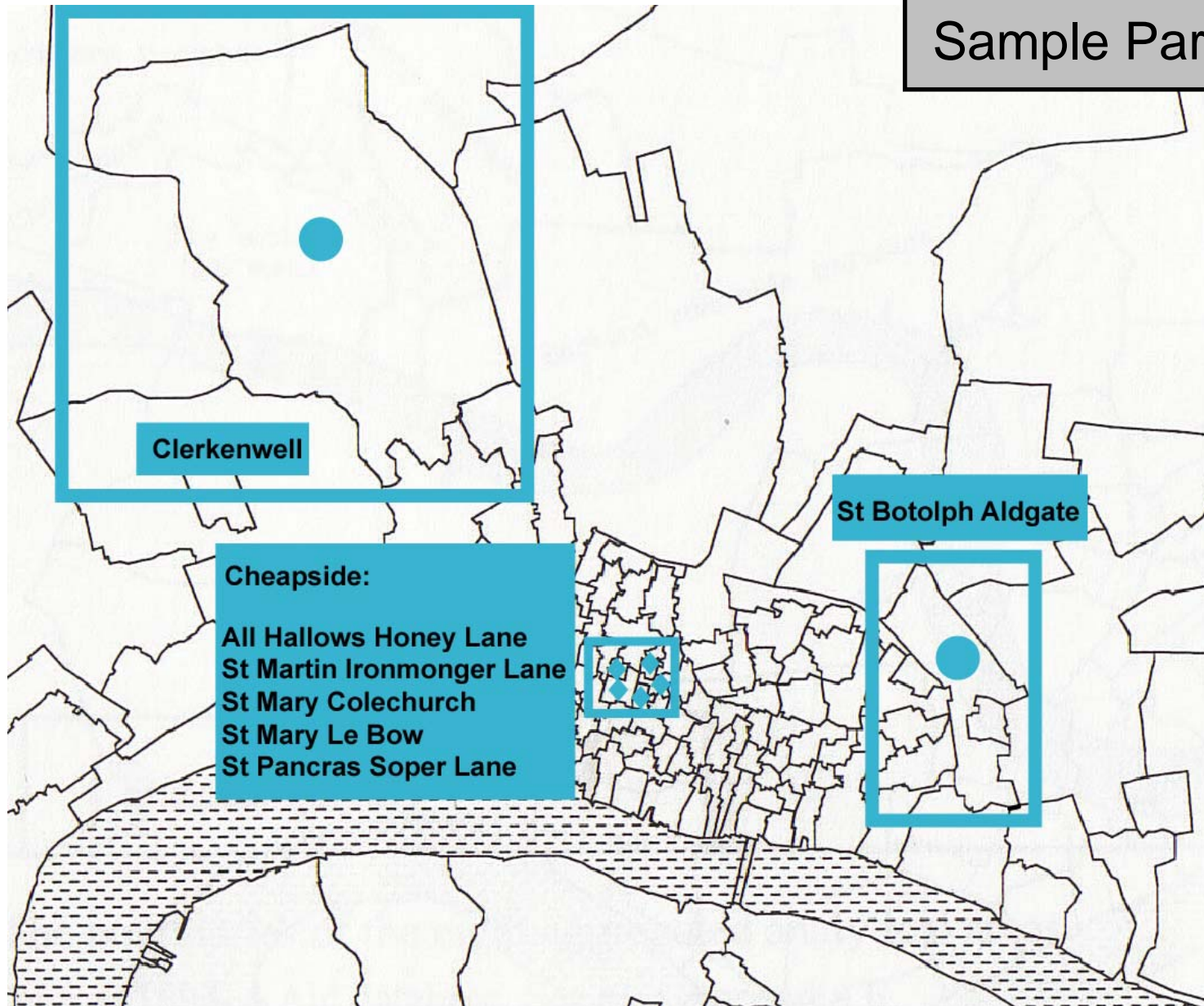

Marriage Duty Assessment 1695

The Respective Names and Qualities of the Sovereign and Respective Inhabitants and their Families of the Parish of St Mary Le Bow London Together with their Several Occasional Payments

Their Names	Qualities	Occasional Payments				Bachelors & Widowers
		Baptisms	Births	Marriages		
John Baptist Peters	Attorney at Law	1-4-0	12	-	-	-
Martha Peters	his wife	- 14 -	-	-	-	-
Richard Peters	his eldest son	- 14 -	-	-	-	-
Martha Peters	his daughters	14	-	-	-	-
Francis Peters		14	-	-	-	-
Edward Harris	his Clerk	- 14 -	-	12-6	-	-
John Lillistone	his maid servt	4	-	-	-	-
John Whitcomb	his foot boy	4	-	-	-	-
William Ramsay	Taylor	0-4-0	2-8	-	-	-
Margaret Ramsay	his wife	0-4-	-	-	-	-
Jarah Ramsay	his daughter	0-4-	-	-	-	-
Elizabeth Ramsay		0-4-	-	-	-	-
Judanna Weston	Apprentice woman	0-4-	-	-	-	-



Poll Tax

St Mary Le Bowe Precinct.		
Marmaduke Ileb and wife & } two Children Mary & Ann —	—	4
William Wood Lodger —	—	1
Mary Wood his sister Lodger —	—	1
Arthur Beltsworth —	00.	11.
two Children Thomas & Arthur —	—	2
A serv ^t maid Martha wages 4 ^l —	—	5
A footboy —	—	1
Momab Wynn and wife —	—	2
a serv ^t maid Hester 40 ^l & 2 ^d —	—	3
a boy William —	—	1
Edward Martin ^s Wife and Child —	—	3
Thomas Light ^s Wife & one Child —	—	3
Three Apprent Thomas. Alex: William —	—	8

Marriage Duty Assessment 1695: Housefuls

John Baker	a Bookkeeper
Mary Baker	his wife
Elizabeth Baker	his daughter
Joseph Lawton	Boatman
Mary Lawton	his wife
Joseph Lawton	his son
James Clerk	his apprentice
Martha Birch	maid servant
James Rauling	gent & widower
Mary Bland	a nurse
Mary Bland	her daughter
Elizabeth Howard	a pouton
Thomas Spence	musician & widower
Benjamin Spence	his son
Bridgett Spence	his daughter
Isaac Witholfson	widow & her
Richard Sparrow	Whiting & Barber
John Edwards	carpenter
Mary Edwards	his wife
Elizabeth Edwards	his daughter
Ann Bradford	maid servant
Thomas Starke	apprentice
Barber	



John Bakewell	a Bookkeeper	1
Mary Bakewell	his wife	
Mary Bakewell		
Isaac Bakewell	his third daughter	
Elizabeth Bakewell		
Joseph Lawtonson	Bolt maker	
Mary Lawtonson	his wife	
Joseph Lawtonson	his son	
James Clarke	his Apprentice	
Martha Birn	maid serv	
James Reeling	gent & widower	
Mary Bland	a Nurse	1
Mary Bland	her daughter	
Elizabeth Howard	a journey	

John Bakewell	a Bookkeeper	1
Mary Bakewell	his wife	
Mary Bakewell		
Isaac Bakewell	his third daughter	
Elizabeth Bakewell		
Joseph Lawtonson	Bolt maker	
Mary Lawtonson	his wife	
Joseph Lawtonson	his son	
James Clerk	his Apprentice	
Martha Birn	maid serv	
James Reeling	gent & widower	
Mary Bland	a Nurse	1
Mary Bland	her daughter	
Elizabeth Howard	a pouton	

Poll Tax: households

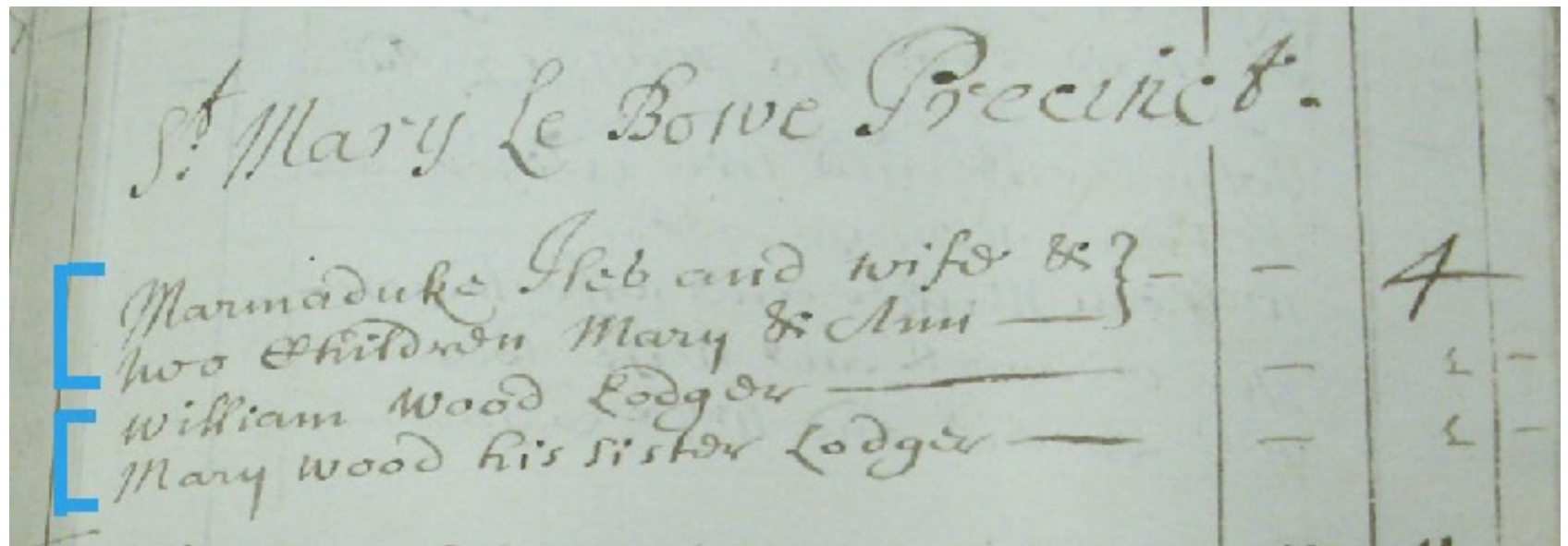

A photograph of a handwritten poll tax record from the St. Mary Le Bowe Precinct. The document is written in cursive on aged paper. It lists households and the number of taxable persons (polls) in each. The first entry is for Marmaduke Heb and his wife, with two children, Mary and Ann, totaling four polls. The second entry is for William Wood, a lodger, with one poll. The third entry is for Mary Wood, his sister, also a lodger, with one poll. The table is organized into columns for names and poll counts.

St. Mary Le Bowe Precinct.			
Marmaduke Heb and wife & }	-	4	
two children Mary & Ann	-	2	-
William Wood lodger	-	1	-
Mary Wood his sister lodger	-	1	-

John Bakewell	[a Bookkeeper	1
Mary Bakewell	[his wife	
Mary Bakewell	[
Elizabeth Bakewell	[his Herd daughter	
Joseph Lawtonson	[Boat maker	
Mary Lawtonson	[his wife	
Joseph Lawtonson	[his Son	
James Clerk	[his Apprentice	
Martha Birch	[maid serv	
James Revelling	[gent & widower	
Mary Bland	[a Nurse	1
Mary Bland	[her daughter	
Elizabeth Howard	[a person	

John Bakewell]	a Bookkeeper	1
Mary Bakewell]	his wife	
Elizabeth Bakewell]		
Joseph Lanyonson]	his Herd daughter	
Mary Lanyonson]	Boat maker	
Joseph Lanyonson]	his wife	
James Clerk]	his Son	
Martha Birch]	his Apprentice	
James Revelling]	maid servant	
Mary Bland]	gent & widower	
Mary Bland]	a Nurse	1
Elizabeth Howard]	her daughter	
]	a person	

John Stone	Bond Collector
Sarah Stone	Ref Wife
Sam ^l Stone	Ref Son
Sarah Stone	Ref Daughter
Nicholas Friess	Bond Collector
Ann Friess	Ref Wife
Ann Friess	Ref Daughter
Mary Friess	Appt
John Russell	Appt
Shrimpton Hodges	Maid Serv 4 3
Mary Thompson	Appt
Briggott Mason	
Richard Hooker	

Cheapside Sample Parishes

Parish	Population	Housefuls	Households	Families	Units
All Hallows Honey Lane	194	26	54	55	125
St Mary Colechurch	358	54	108	111	183
St Martin Ironmonger Lane	254	40	82	82	213
St Mary Le Bow	672	105	185	188	429

Parish	Mean HF Size	Mean HH Size	Mean FAM Size	Mean Unit Size
All Hallows Honey Lane	7.5	3.6	3.5	1.6
St Mary Colechurch	6.6	3.3	3.2	2.0
St Martin Ironmonger Lane	6.4	3.1	3.1	1.2
St Mary Le Bow	6.4	3.6	3.1	1.6
Non-metropolitan national average (Laslett)	4.71			

Cheapside Sample Parishes

Parish	Population	Housefuls	Households	Families	Units
All Hallows Honey Lane	194	26	54	55	125
St Mary Colechurch	358	54	108	111	183
St Martin Ironmonger Lane	254	40	82	82	213
St Mary Le Bow	672	105	185	188	429

Parish	Mean HF Size	Mean HH Size	Mean FAM Size	Mean Unit Size
All Hallows Honey Lane	7.5	3.6	3.5	1.6
St Mary Colechurch	6.6	3.3	3.2	2.0
St Martin Ironmonger Lane	6.4	3.1	3.1	1.2
St Mary Le Bow	6.4	3.6	3.1	1.6
Non-metropolitan national average (Laslett)	4.71	4.71		

St Mary Le Bow and St Botolph Aldgate, 1695

[illegible]

High-street p^{er}met

George
qualit
Estab

Joseph Quaker
Henry Lofley
John Hoston } do
Ch^{as} Dyer } do
Sam^l Thompson } do
his wife } do
Sarah A. Lofley } do
James Mansfield } do
Walker & Co } do
Elizabeth Joseph } do
Ch^{as} Baker } do
Ruth Lofley
Wm^l a. Smith
Elizabeth Hoston
John Greene
Elizabeth his wife
John J. Dickinson
Ch^{as} J. Dickinson
John Gentry
Mary his wife
Sarah
James Dutton
Anna his wife
Ch^{as} Dutton
Anne Wood
James Dutton
John Hayball
John Miller

11/2

ALL HALLOWS HONEY LANE: 2

This tenement, on the W. corner of Honey Lane and Cheapside, was bounded to the W. by 1 and to the N. by 3.

In 1858 this was no. 112 Cheapside.

i. THIRTEENTH TO SIXTEENTH CENTURY

In 1231 this was probably the tenement of Jocus son of Peter Serlon which lay to the S. of 3. Peter Serlon was probably a successor of Serlo le Mercer, who in the early 13th century appears to have held 2 and other properties near by. In 1235 the king confirmed Serlo le Mercer's gifts to the convent of St. John the Baptist, Haliwell (fd. bef. 1150), which included his share of the lands, houses, and shops which he and Solomon de Basing had in *Hunyke* of the fee of Thomas de Haverhull, his share of the lands and houses he and Solomon had there of the fee of Martin son of William, and his share of the moiety of a seld with shops and solars which he and Solomon had in Cheapside in the parish of All Hallows Honey Lane of the fee of John Herlicun. It is possible that only the 3rd of these properties is 2, in Cheapside and Honey Lane, but if so it is not clear precisely where the other properties lay; at a later date 2 was the only property of Haliwell Priory in this parish. The nuns of Haliwell had erected a pentice in Cheapside by 1246.

The property was charged with several quit-rents, the origins of which are obscure. In 1283, Hugh de Bedeford and his wife Joan distrained in the tenement for arrears of 40s. of a rent of £1. 6s. 8d. which they claimed the prioress of Haliwell's tenants were bound to pay them. She denied liability, and again in 1286 Hugh and Joan took nam of a blanket (*chalon*), a balance, and 3 furs of lambskin, for £1. 13s. 4d. arrears of the same rent. The prioress again denied that Hugh and Joan were in seisin of the rent by her hands or her

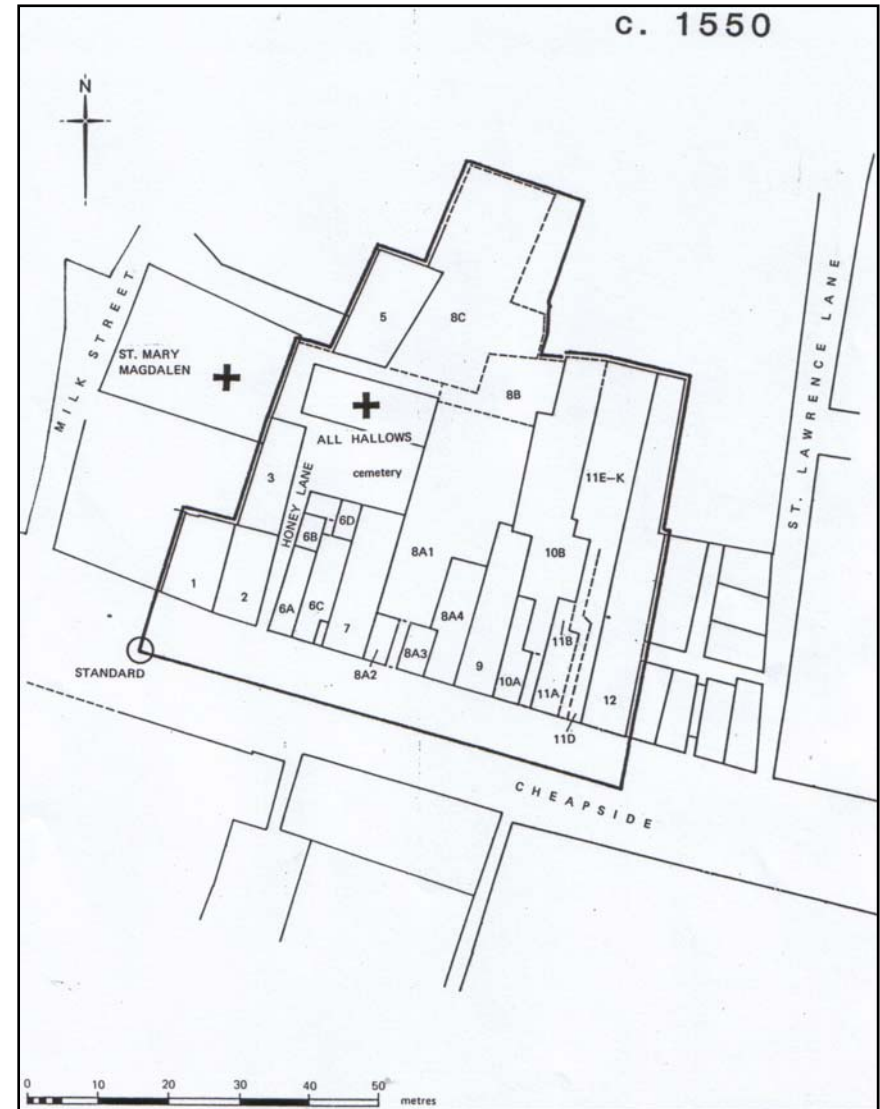

The Cheapside Gazetteer